

# Rolling Unit

by MARU



**The unique lightweight fold out vehicle that allows for more expandable space without compromising interior space in transport.**

**The Clever alternative** for big, heavy expensive trucks trailers and traditional slide outs.

# Endless opportunities



BASIC TRUCK



XL TRUCK



1-IN-1 TRUCK



BASIC TRAILER



XL TRAILER



CUSTOM SOLUTIONS

# Benefits

- Up to 33 m<sup>2</sup> of usable space on car trailer or chassis cab without the need for big truck. Save costs in purchase and maintenance.
- Allows for more expandable space than a traditional slide-out without decreasing usable space inside.
- Can be driven with a car or van license, no professional truck drivers required.
- Less back and forth logistics when compared to multiple small trailers, save time and reduce costs.
- Excellent insulation due to sandwich panel construction – usable all year.
- Better manoeuvrability compared to long trailers or trucks.
- Shelter can be detached from vehicle – lifetime of superstructure is not limited by vehicle.
- Due to container and subframe, construction can be attached to any kind of chassis. No dependency on the base vehicle.
- Flush floor.
- Easy to use and reliable with no complex mechanics.
- Made from long lasting materials and hardware.
- Quick and easy set up.
- Lightweight – an empty long 3 in 1 shelter weighs only 1700 kg.
- Walkable roof option.
- Highly customisable.
- Eye catching and innovative product.
- Small footprint on the parking lot, when not in active use.



## **Space**

Three times the space of a standard solution

- 25 m<sup>2</sup> of workspace
- Higher capacity
- Various opportunities for use



## **Comfort**

The look and functionality as requested by you

- Weatherproof up to -20 °C
- Great ventilation
- Easier access



## **Mobility**

15 min setup time

- Use your own car to transport the trailer
- Customisable for various towing vehicles
- Suitable for category B vehicles
- Certified and compliant



## **Return on investment**

The least expensive way to expand your business

- Increases service coverage
- Low maintenance costs
- A different and eye-catching marketing vehicle

# We help turn your idea into a final product

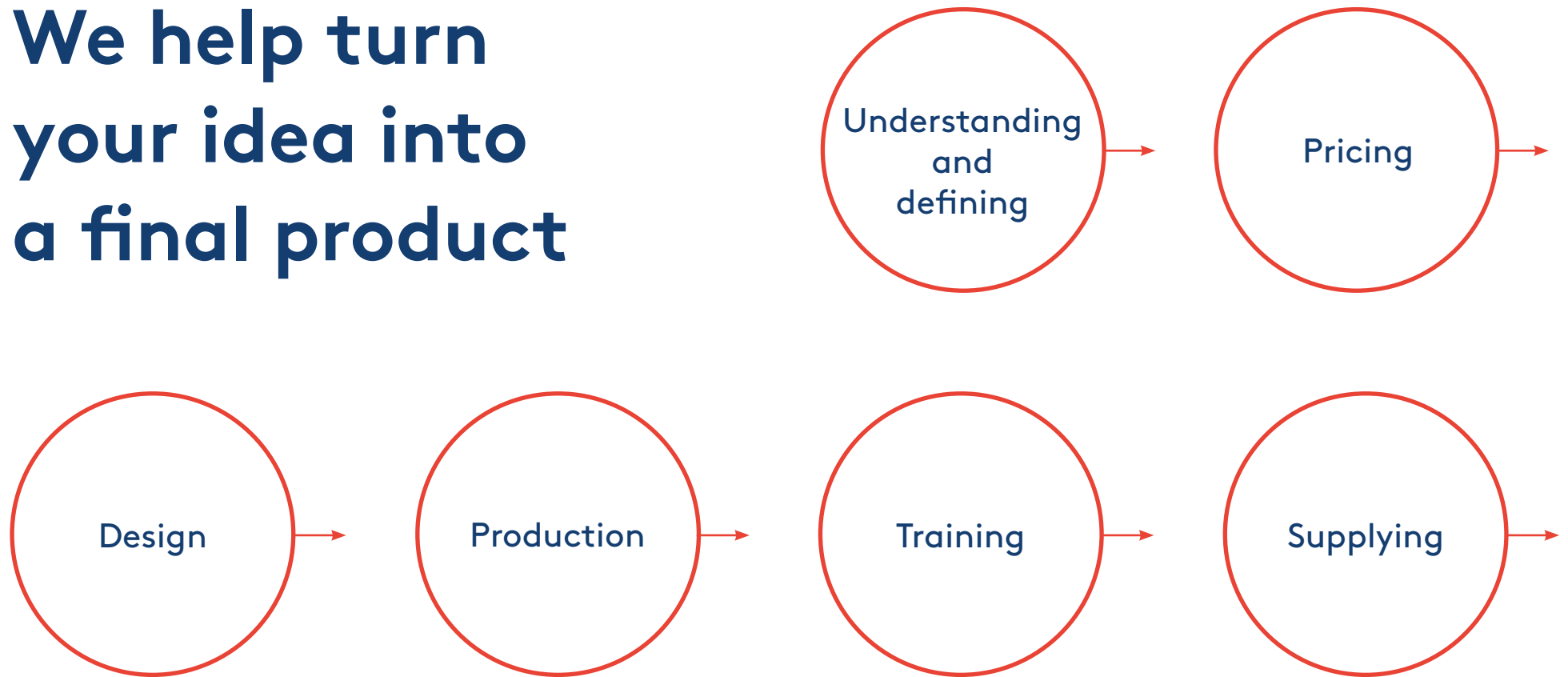

# Why us?



## ***Customer satisfaction***

- Flexibility
- Reliability
- Speed and accuracy



## ***Manufacturing capacity and technology***

- 2500 m<sup>2</sup> of production space
- Modern equipment
- Customised production facility



## ***Competence and experience***

- 10 years in business
- Experience in the military, rescue and medical fields
- Highly qualified team



# Basic truck

The Rolling Unit Basic truck can be a 2 in 1 or 3 in 1 solution. Shelter length can vary from 4 m to 5,7 m. Expansion length is 3,8 m and 1,9 m wide. Additional separation walls can be added to form separate rooms. Automated levelling system is always included on the basic truck.



Scan to  
watch video



## The 3-in-1 shelter

|                           |  |
|---------------------------|--|
| Gross vehicle weight:     | 3500 – 7200 kg   |
| Load capacity:            | up to 2600 kg  |
| Weight of Shelter:        | 1400 – 1700 kg   |
| Total length of shelter:  | 5706 mm  |
| Height:                   | 3000 – 3200 mm   |
| Insulation:               | 40 – 80 mm   |
| Width in transport:       | 2312 mm  |
| Width when opened:        | 5852 mm  |
| Floor area in transport:  | ~9 m <sup>2</sup>  |
| Floor area when expanded: | ~24 m <sup>2</sup>   |
| Additional information:   | 4 windows, frosted glass, lightweight stairs, aluminium external door with standard lock |

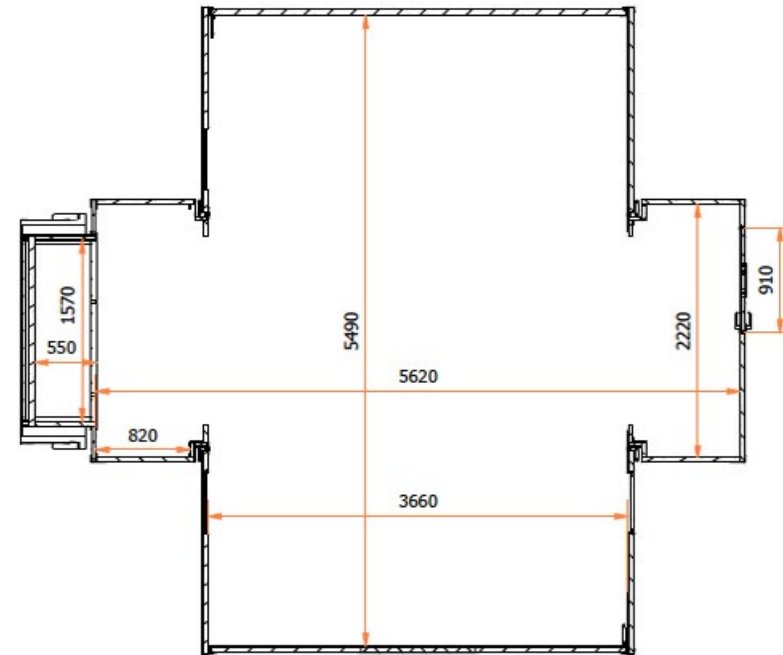



Rolling Unit  
by MARU

IVECO

065 MSN

WATER SOLUTIONS  
ENTER



Rolling Unit  
by MARU

Rolling Unit  
by MARU

Tunne ennast võitjana!

PEETRI  
JOOKS

www.peetrijooks.ee

elico

Moller Auto

INTEC

PEETRI  
JOOKS

www.peetrijooks.ee

elico

Moller Auto

INTEC

INTEC

INTEC

INTEC

INTEC

INTEC

INTEC

IVECO

065 MSN

# XL truck

When expanded, the unit offers 33 m<sup>2</sup> of expandable space on an Iveco Daily chassis. Additionally it offers an extra high ceiling with minimal internal height of 2,2 m. It is the best solution if you need maximum square meters combined with a 2,5-t load capacity. A better value for the money solution, with less than half the carbon print of a full semi-trailer. Additional separation walls can be added to form separate rooms.



*Scan to  
watch video*



## The truck

|                           |  |
|---------------------------|--|
| Gross vehicle weight:     | 7200 kg  |
| Load capacity:            | up to 2600 kg  |
| Weight of Shelter:        | 2500 kg  |
| Total length of shelter:  | 6000 mm  |
| Height:                   | 3300 mm  |
| Insulation:               | 50 – 80 mm   |
| Width in transport:       | 2312 mm  |
| Width when opened:        | 6000 mm  |
| Floor area in transport:  | ~10 m <sup>2</sup>   |
| Floor area when expanded: | ~33 m <sup>2</sup>   |
| Additional information:   | 4 windows, frosted glass, lightweight stairs, aluminium external door with standard lock |

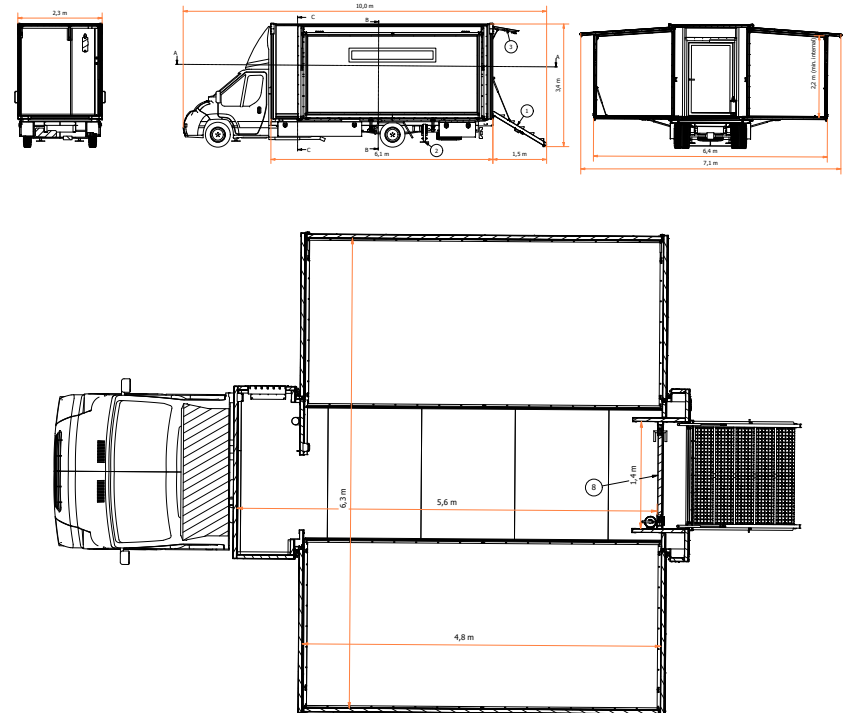







# Basic 1-in-1 truck shelter

Sometimes expansion is not required, we can use our technology and know-how to produce nonexpanding lightweight shelters. Still you get the benefit on excellent insulation and subframe construction which will outlive the vehicle.



*Scan to  
watch video*



## The 1-in-1 shelter

---

|                                |  |
|--------------------------------|--|
| Tare weight:                   | 950 kg   |
| Total length of shelter:       | 6350 mm  |
| Width of shelter:              | 2310 mm  |
| Internal height:               | 2200 mm  |
| Height of shelter from ground: | ~3250 mm   |
| Insulation:                    | 40-80 mm   |
| Floor area:                    | ~12 m <sup>2</sup>                                 |
| Additional information:        | stairs, aluminium external door with standard lock |

---





# Basic trailer

Most flexible and cost-effective solution as you don't need a dedicated vehicle, can be towed by a car SUV or a van that you already have. Doesn't require truck driver's license, BE category is only needed. It has a carrying capacity of 1000 kg and 10 m<sup>2</sup> space for equipment in transport mode. Load all your equipment into the trailer, drive on site, expand and start working in the spacious comfortable 24 m<sup>2</sup> environment. Manual levelling legs are included.



Scan to  
watch video



## The trailer

|                                |  |
|--------------------------------|--|
| Gross trailer weight:          | 3500 kg  |
| Tare weight of trailer:        | 2400 kg  |
| Total length of trailer:       | 7200 mm  |
| Total width of trailer:        | 2300 mm  |
| Platform surface area:         | 5500 x 2300 mm (length x width)                            |
| Axis:                          | torsion 2 x brake (a '1800 kg)                             |
| Brakes:                        | 4 x drum brakes  |
| Coupling head:                 | 50 mm ball attachment                                      |
| Support legs:                  | 4 support legs in corners, height adjustable to max 356 mm |
| Total length of shelter:       | 5706 mm  |
| Height of trailer:             | 3000 mm  |
| Insulation:                    | 40 – 80 mm   |
| Width of shelter in transport: | 2312 mm  |

|                           |   |
|---------------------------|---|
| Width when opened:        | 5852 mm   |
| Floor area in transport:  | ~9 m <sup>2</sup>   |
| Floor area when expanded: | ~24 m <sup>2</sup>  |
| Additional information:   | 2 windows, lightweight stairs, aluminium external door with standard lock |

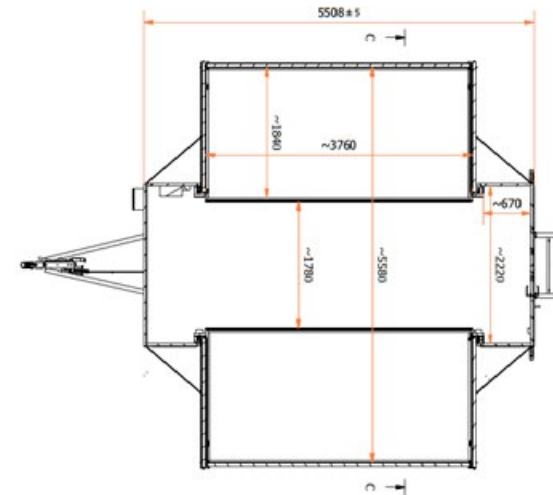

*Täname kõiki annetajaid!*

*Jõulutunnel*

2015



**EESTI VÄHILIIDU  
DIAGNOSIKABINET**

134 YKB



**EESTI VÄHILIIDU  
DIAGNOSTIKABINET**

**EESTI VÄHILIIDU  
DIAGNOSTIKABINET**

  
Eesti Vähiühendus  
Estonian Cancer Society

 Eesti  
Haigekassa





# XL trailer

The XL trailer offers an enormous 30 m<sup>2</sup> space while still operatable with the BE license, which like the basic model can be towed with a van, bigger SUV or a pick-up truck. It has a carrying capacity of 600 kg and 9 m<sup>2</sup> space for equipment in transport mode.



*Scan to  
watch video*



## The trailer

|                                |  |
|--------------------------------|--|
| Gross trailer weight:          | 3500 kg  |
| Tare weight of trailer:        | 2900 kg  |
| Total length of trailer:       | 7200 mm  |
| Total width of trailer:        | 2300 mm  |
| Platform surface area:         | 5500 x 2300 mm (length x width)                            |
| Axis:                          | torsion 2 x brake (a '1800 kg)                             |
| Brakes:                        | 4 x drum brakes  |
| Coupling head:                 | 50 mm ball attachment                                      |
| Support legs:                  | 4 support legs in corners, height adjustable to max 356 mm |
| Total length of shelter:       | 5706 mm  |
| Height of trailer:             | 3000 mm  |
| Insulation:                    | 50 – 80 mm   |
| Width of shelter in transport: | 2312 mm  |

|                           |   |
|---------------------------|---|
| Width when opened:        | 5852 mm   |
| Floor area in transport:  | ~9 m <sup>2</sup>   |
| Floor area when expanded: | ~30 m <sup>2</sup>  |
| Additional information:   | 2 windows, lightweight stairs, aluminium external door with standard lock |

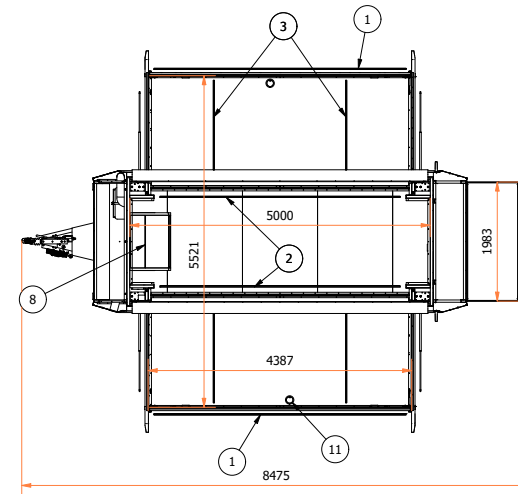





# Tartu University Hospital Cancer Screening Trailers

Tartu University Hospital is using two of our trailers as cancer-screening vehicles. They have been in operation since 2016 and have traveled over 100 000 km with minimal standard maintenance required in that time.

Tartu University has relied on Rolling Unit's reliability in weather -20°.

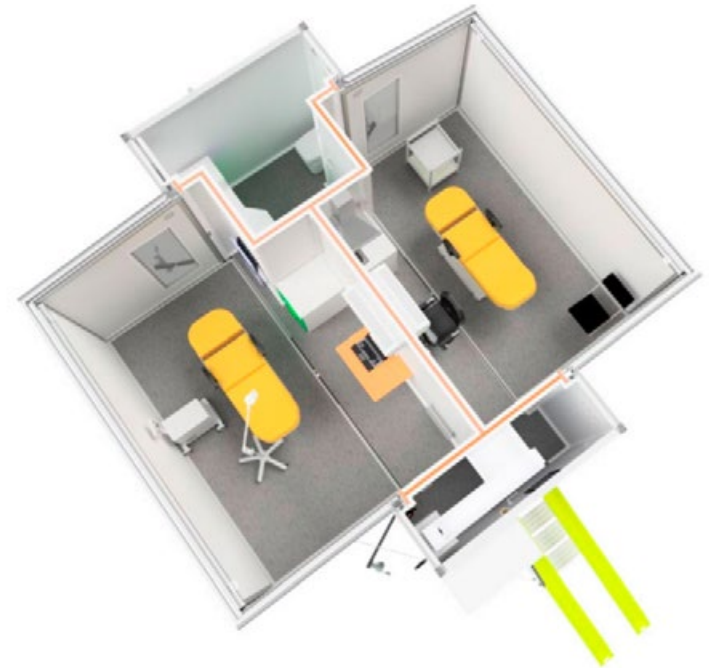



# ABC Kompuuter Mobile Photo Finish and Time Measuring Truck

Rolling Unit customer ABC Kompuuter needed a modern solution to replace an old bus that was retrofitted to measure race times. The bus had several disadvantages from insulation in extreme weather, costly maintenance, outdated look and functionality. To bring ABC Kompuuter's operation up to date, Rolling Unit's custom shop worked to outfit the new vehicle with our unique insulation, ample space, extra workspaces, attractive look, along with additional customised rooms for rest and shower. This was all achievable for our client with the 3-in-1 Rolling Unit truck.





# Estonian Biathlon Association Ski-service Truck

3-in-1 XL Truck mounted on an Iveco Daily chassis to form a unique ski-service vehicle that rivals facilities employed by top national teams. A better value for the money, with less than half the carbon print of a full semi-trailer.

The internal height minimum 2,2 m allows for that even that the longest cross country skies can be stored in an upright position in the unit. Additionally, the layout is flexible and can be rearranged for different tasks.



# Qvalitas Mobile Health Clinics

Qvalitas Mobile Health Clinics serve as mobile eye clinics with added vaccination capabilities. Qvalitas trucks were in the forefront of the vaccination efforts in Estonia during 2021 COVID crisis.



# Synlab Medical Trailers

Synlab's medical trailers are used for PCR tests and antibody tests. Thanks to the mobile nature of the testing facilities they can be deployed where an infectious hot spot occurs. Thanks to being a separate trailer, auxiliary operations can remain infection free. Due to expanded nature of the trailer distance requirements can be achieved easily.





**OÜ MDSC Systems**  
Järvevana tee 5  
10132 Tallinn, Estonia  
[www.rollingunit.com](http://www.rollingunit.com)

Phone: +372 650 8820  
[info@rollingunit.com](mailto:info@rollingunit.com)

MDSC Systems OÜ specialises in designing and manufacturing mobile and relocatable solutions for military, rescue and medical use. We began as an affiliate of AS Maru Metall and have been operating independently under the name of MDSC Systems OÜ since 2015.

